

REV.	EQ. NO.	MODIFY CONTENT	DATE
A		NEW	2019/10/21

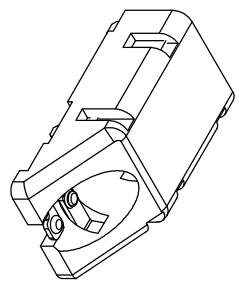

NOTE:

- 一. 材质及电镀方式 (MATERIAL AND FINISH)
- 1. 塑胶 (HOUSING): LCP, UL 94V-0, COLOR: BLACK
- 2. 端子 (CONTACT): COPPER ALLOY
- GOLD FLASH PLATING ON CONTACT AREA,
- GOLD FLASH PLATING ON SOLDER TAILS
- 40μ" NICKEL UNDER PLATING OVER ALL

- 二. 机械特性 (MECHANICAL CHARACTERISTICS)
- 1. 插入力 (Insertion Force): 2.5Kgf Max
- 2. 拔出力 (Withdrawal Force): 0.25Kgf Min
- 3. 耐久性 (Durability): 5000次

- 三. 电气特性
- 1. 额定电流 (Current rating): 1.0A AC/DC
- 2. 接触电阻 (Contact resistance): 100mΩ MAX
- 3. 绝缘电阻 (Insulation resistance): 500MΩ MIN
- 4. 适用温度 (Operating temperature): -20℃~65℃

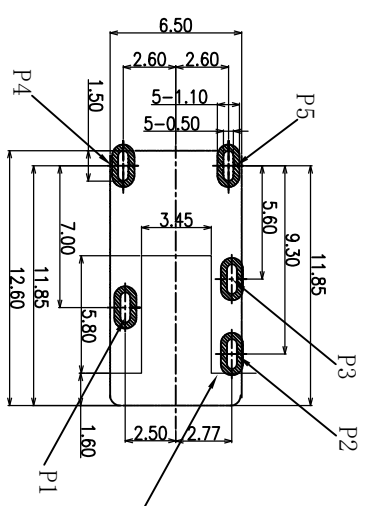
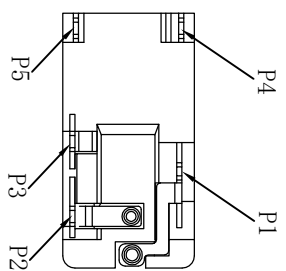
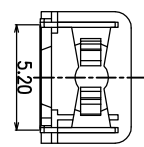
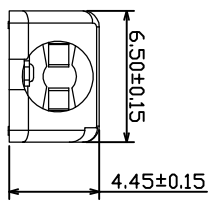
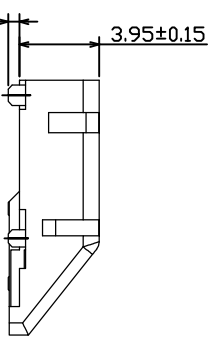
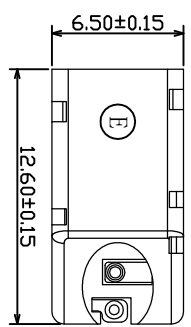

RECOMMENDED PCB LAYOUT
TOLERANCE=±0.05

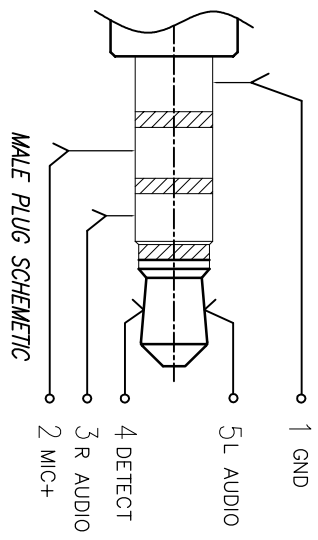

GENERAL TOLERANCE		DWG NO.	APPD:	WIND	Scale
X.±0.45	X.±5'	JYSA0528-001			1:1
X±0.35	X.±2'	Title	CHKD:		mm
.XX±0.25	.XX±1'	Part NO.	DR:		
.XXX±0.15	.xxx±0.5'		Date	2019/10/21	
SHEET 1/1					

JYSCONN Shenzhen
JYSCONN Electronics Co., LTD.