

REV.	ECN.NO.	MODIFY.CONTENT	DATE
A0		NEW	2021/03/16

PIN ASSIGNMENTS:

A1	A2	A3	A4	A5	A6	A7	A8	A9	A10	A11	A12
GND	TX1+	TX1-	Vbus	CC1	D+	D-	SBU1	Vbus	RX2-	RX2+	GND
B12	B11	B10	B9	B8	B7	B6	B5	B4	B3	B2	B1
GND	RX1+	RX1-	Vbus	SBU2	D-	D+	CC2	Vbus	TX2-	TX2+	GND

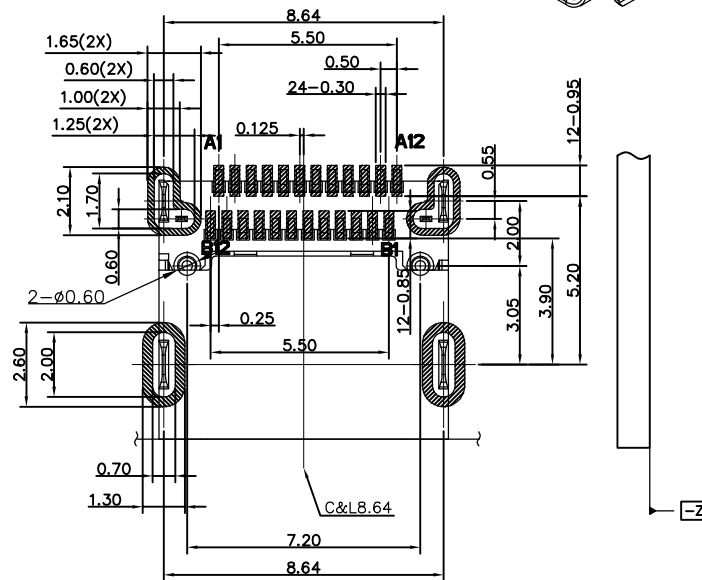
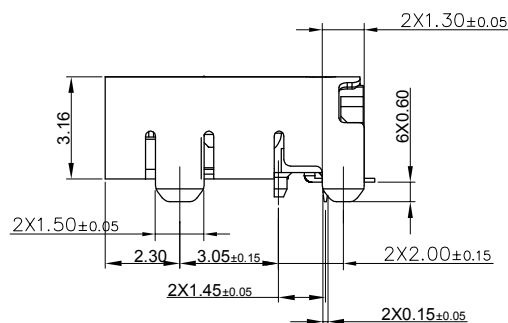
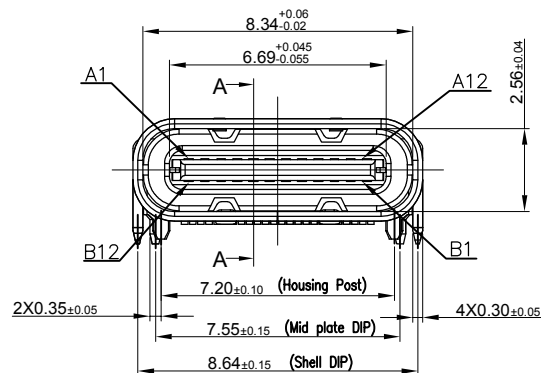
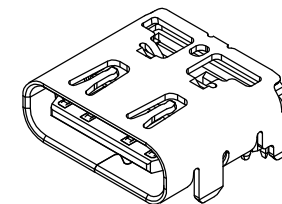
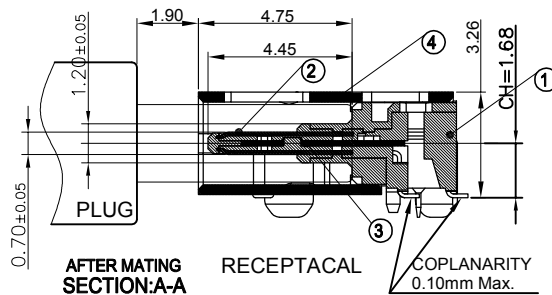
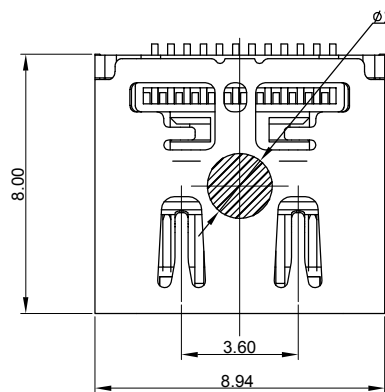

RECOMMENDED PCB LAYOUT (THICKNESS: 0.80MM)
PWB TOLERANCE: ±0.05

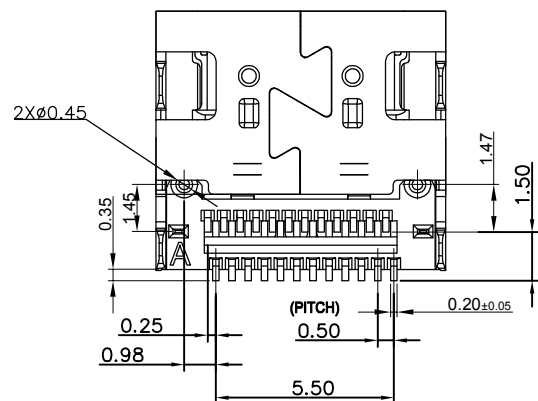

SPECIFICATION:

1. ELECTRICAL CHARACTERISTICS:

- 1.1 CURRENT RATING: 1.5A/Pin MAX(A4,A9,B4,B9)
1.25A/Pin MAX(A1,A12,B1,B12), 0.25A(OTHER PIN)
- 1.2 CONTACT RESISTANCE: 40 MILLIONHM MAX.
- 1.3 DIELECTRIC WITHSTANDING VOLTAGE: 100 VAC r.m.s
- 1.4 INSULATION RESISTANCE: 100 MEGOHMS MIN.

2. MECHANICAL CHARACTERISTICS

- 2.1 INSERTION FORCE: 5-20N
- 2.2 EXTRACTION FORCE: Initial: 8-20N; Durability: 8-20N(1000cycles);
- 2.3 DURABILITY: 10,000CYCLES

3. ENVIRONMENTAL CHARACTERISTICS

- 3.1 TEMPERATURE RANGE: -40 °C ~ 85 °C
- 3.2. IR REFLOW:

THE PEAK TEMPERATURE ON THE BOARD SHALL BE MAINTAINED FOR 10 SECONDS AT 260°C.

④	SHELL	STAINLESS STEEL	NI Plated	1PCS
③	CENTER PLATE	STAINLESS STEEL	NI Plated	1PCS
②	CONTACT	COPPER ALLOY	Au/Ni Plated	2SET
①	HOUSING	HIGH TEMPERATURE PLASTIC	BLACK	1PCS
NO.	DESCRIPTION	MATERIAL	REMARKS	QTY

GENERAL TOLERANCE	DWG NO.	APPD:	Scale	1:1
X.±0.25	x.'±5'	Title	UNIT	mm
.X±0.20	.x'±2'	Part NO.	Date	2021/03/16
.XX±0.15	.xx'±1'	JYS-UTC864-126		
.XXX±0.10	.xxx'±0.5'			
SHEET	1/2	Shenzhen JYSCONN Electronics Co., LTD.		

REV.	ECN.NO.	MODIFY.CONTENT	DATE
AO		NEW	2021/03/16

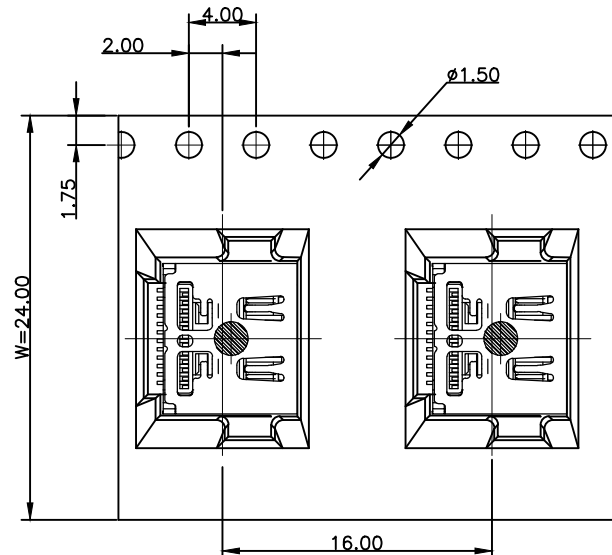
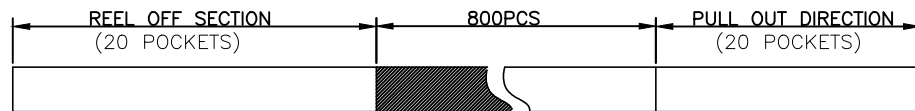

← PRODUCT PACKAGING DIRECTION
 CUSTOMER TO USE DIRECTION →

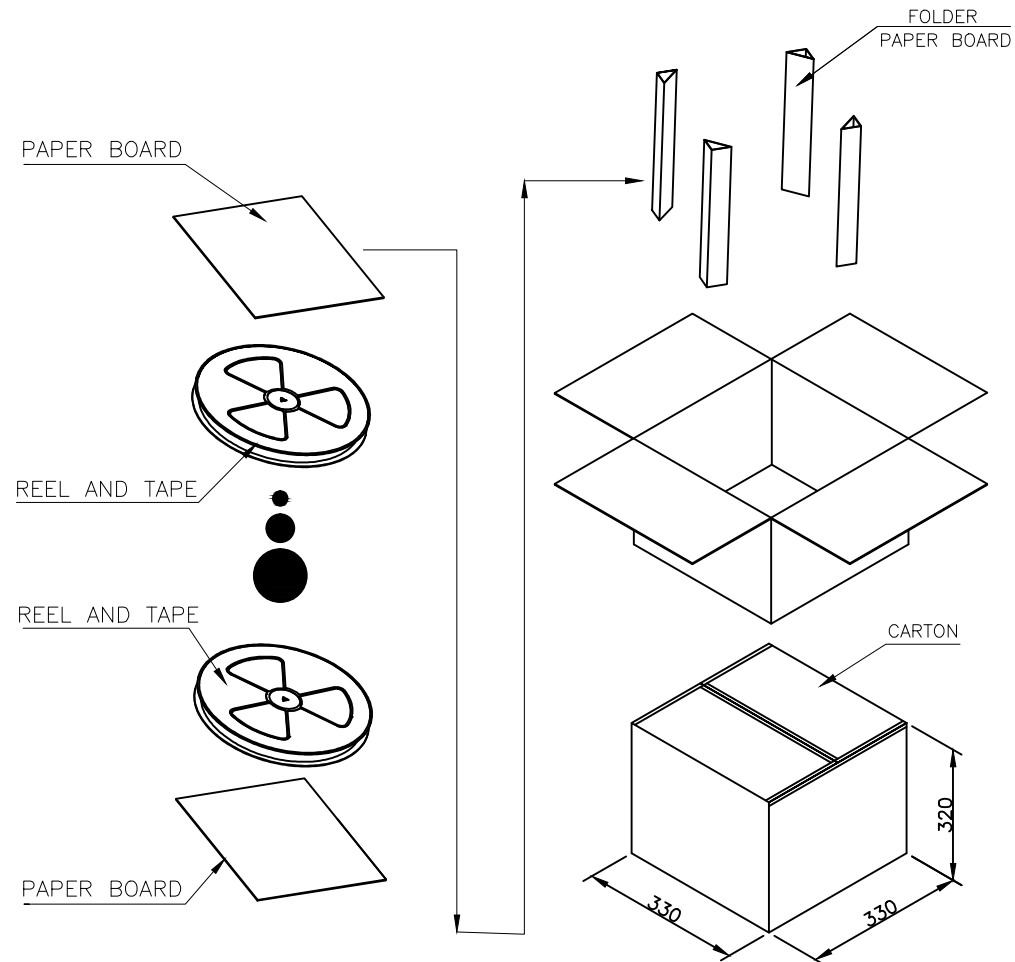
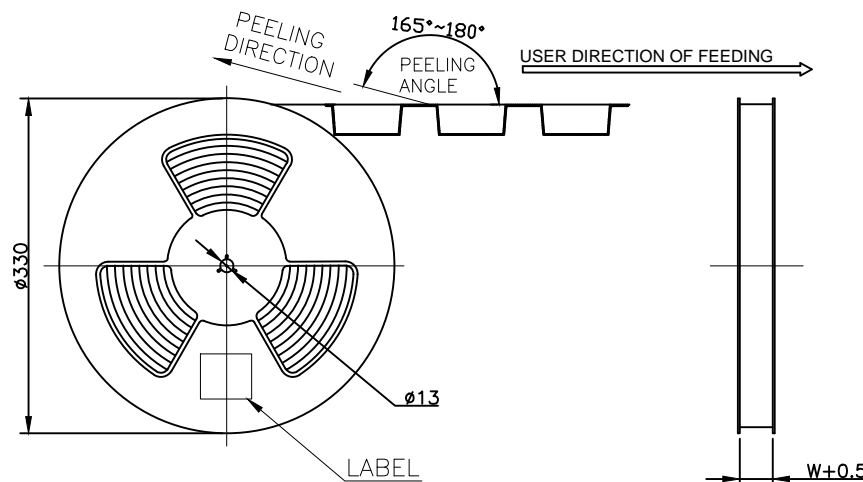

CONN. PART NO.	CONN. QTY./REEL	REEL QTY./CARTON	CONN. QTY./CARTON
JYS-UTC864-126	800	10	8000 PCS

GENERAL TOLERANCE		DWG NO.	APPD:		Scale	1:1	
X.±0.25	x.±5'	Title	USB Type C 3.1 母座 有后盖 单壳 双贴SMT 板上平贴,L=8.00mm		CHKD:	UNIT	mm
.XX±0.20	.xx'±2'		DR:				
.XX±0.15	.xx'±1'	Part NO.	JYS-UTC864-126	Date	2021/03/16		
.XXX±0.10	.xxx'±0.5'						